

CRV:

The Curve Unit

The Device:

The Glide-Line™ Curve Unit is designed to transfer pallets around the corner of a conveyor system. The Curve Unit utilizes a combination of a polycord, rollers, and guides to consistently transfer pallets around the intersection of two conveyors.

Two standard versions of the Curve Unit are for transferring a pallet 90 degrees and 180 degrees. Other transfer degrees are available on request.

Curves can be set up to be slaved off an adjacent conveyor drive, so long as the drive is placed 187mm from the end of the conveyor. The Curve Unit also has self-powered configurations with 1/4HP AC powered options, as well as 24VDC Powered options.

Glide-Line™ Curve Units can also support stand-alone supports, and tandem supports. This is often a good solution if standard leg sets on the adjacent conveyors cannot be placed close enough to the end of the layout. Consult the Leg Set manual in the Glide-Line™ Conveyor section for more information.

Curves are not suitable for accumulation, and require single pallet flow to prevent jamming. Reference the Glide-Line™ Stops section to find more information on stops that are suitable for Glide-Line™ Pallet singulation.

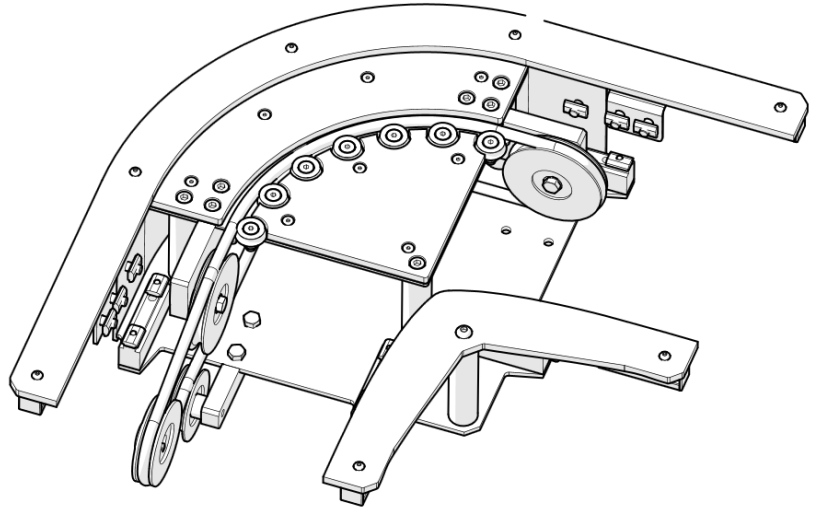

Part Number:

CRV-(A)-(B)-(C)-D(D)-S1(E)-S2(F)

- A** = Pallet Width range 160mm to 400mm
- B** = Pallet Length range 160mm to 400mm
- C** = Degrees of turn, Currently **25** to **180** Available
- D** = Drive Type, **EXT** for Slave, **AC** for AC powered, **DC** for 24VDC Powered
- E** = Connection option side one, **D187** to slave to conveyor with drive position 187mm, **R** for standard return
- F** = Connection option side two, **D187** to slave to conveyor with drive position 187mm, **R** for standard return

Technical Specifications

Pallet length range	160mm to 400mm in 1mm increments
Pallet width range	160mm to 400mm in 1mm increments
Allowable Length to Width Ratio	1.5:1
Max Pallet Weight	20KG (42Lbs.)

The Tandem Curve:

The Tandem Curve Unit allows pallets to transfer to/from parallel conveyor lanes, maintaining the leading edge of the pallet as it travels. The unit provides an economical approach to lane transfers, and if slaved can save several drives required for a traditional solution. Gap between conveyors can range between 45mm and 350mm in 1mm increments. Optionally available is the Tandem curve leg set (shown right), allowing for the end of the conveyor system to be properly supported.

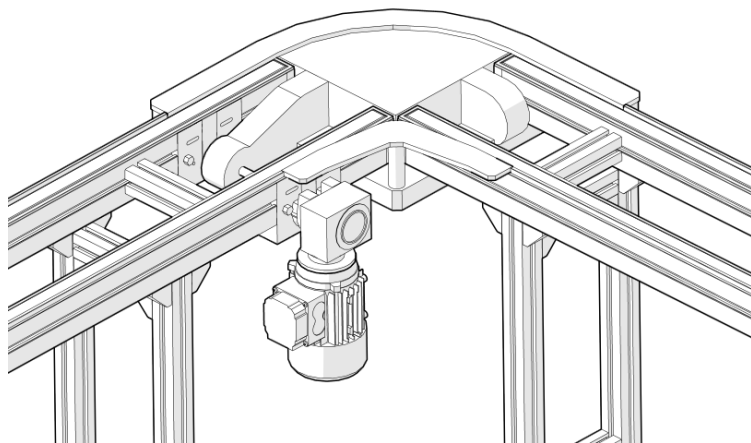
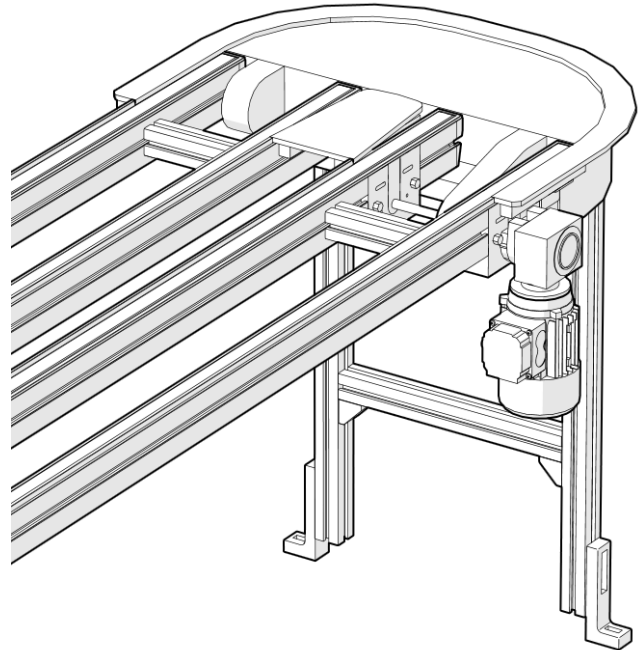
Slaving the Device to Conveyors:

Curve units are easily slaved to adjacent conveyors, saving drives for economical layout solutions. Drive box position on driving conveyor must be set to 187mm.

Less than 90 Curves:

The Glide-Line™ Curve design can accommodate curve angles from 15 degrees to 90 degrees in 1 degree increments. This allows for a higher degree of layout flexibility than previously possible.

